



3 Bed  
Flat - Purpose Built  
located in

Asking price £425,000



TAYLOR  
MICHAEL



# Drive Lodge, 68-70 The Drive, Hove, BN3 3PS

Approximate Gross Internal Area = 91.3 sq m / 983 sq ft

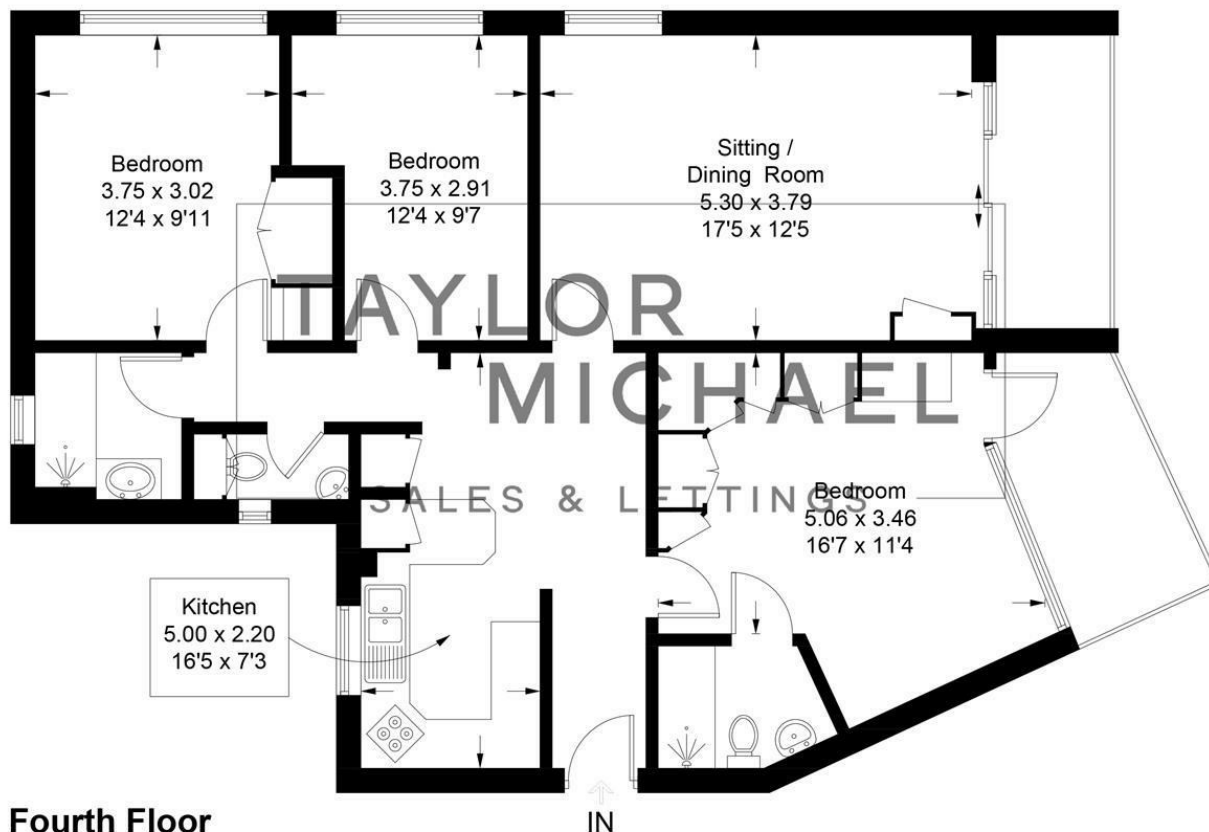

Illustration for identification purposes only, measurements are approximate, not to scale.  
Imageplansurveys @ 2026

| Energy Efficiency Rating                    |         |           |
|---|---------|-----------|
|   | Current | Potential |
| Very energy efficient - lower running costs |         |           |
| (92 plus) <b>A</b>                          |         |           |
| (81-91) <b>B</b>                            |         |           |
| (69-80) <b>C</b>                            | 79      | 81        |
| (55-68) <b>D</b>                            |         |           |
| (39-54) <b>E</b>                            |         |           |
| (21-38) <b>F</b>                            |         |           |
| (1-20) <b>G</b>                             |         |           |
| Not energy efficient - higher running costs |         |           |
| EU Directive 2002/91/EC                     |         |           |
| England & Wales                             |         |           |

## DIRECTIONS

## CONTACT

62 Church Road  
Hove  
East Sussex  
BN3 2FP

E: [lettings@taylormichael.agency](mailto:lettings@taylormichael.agency)  
T: 01273 600100  
<https://taylormichael.agency/>

**TAYLOR**  
**MICHAEL**